

## ISA 1932 flow nozzles

### Construction:

Manufactured in according to ISA 1932, UNI 1563-1564, BS 1042-1964, 1S0 R541, DIN 1952 and AFNOR NF X10-102.

### Types:

- flanged type with piezometric ring - fig. 1
- flanged type with corner taps - fig. 1
- welding in type with holding ring - fig. 4
- welding in type without holding ring - fig. 3 with «m» less than 0,45 ( $d < 2/3D$ )
- with «m» greater than 0.45 ( $d > 2/3D$ ) - fig. 2.

### Materials:

- flow nozzle: from forged piece
- holding ring: in the same material off flow section
- pins: from bar-stock AISI 316.

### Dimensions:

flow nozzle: all dimensions  
flow section: maximum length: 100".

### Checking:

flow nozzle outline inspected with male and female gauge.

### Pressure taps:

in the same material of the flow section with execution under to 800°F or from 800°F to 1100°F.

### Flow nozzle, flow section and companion flange:

material to be specified.

### Flow calculations:

when required and extra price, flow calculation can be made for determining throat diameter and nozzle shape. In this case, please to specify all data specified under Flow Calculation.

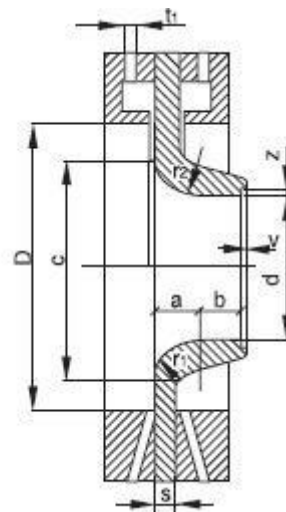

fig. 1

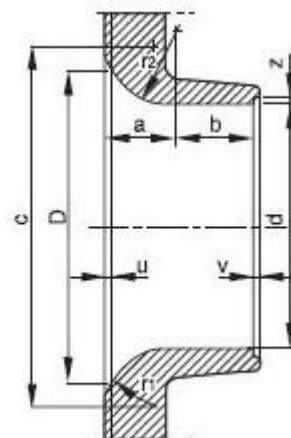

fig. 2

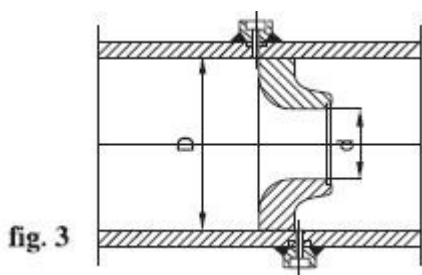

fig. 3

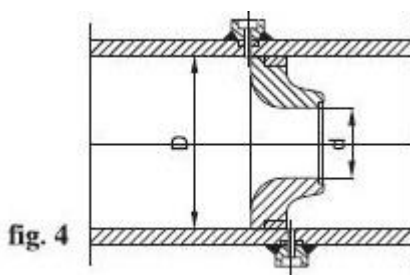

fig. 4

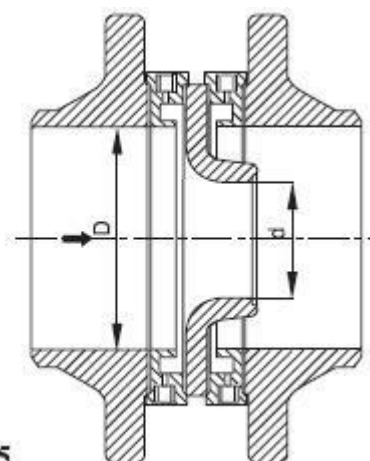

fig. 5

PIROVAT SISTEMAS, S.L.

POL. IND. PLA DE VIDRERES – C/ B, NAVE 7 - 17411 VIDRERES (GIRONA) - SPAIN

Tel. 0034972850607 Fax. 0034972875590 email: admin@pirovat.com - [www.pirovat.com](http://www.pirovat.com)